

# L1A Series

FLUORESCENT | SURFACE **S**



**1 LAMP TUFF LITE  
IP-RATED APPLICATIONS:**

- UL/CUL Listed Wet Location
- Industrial & Commercial
- UL Listed Marine (Inside, Drip-Proof)
- Transit

**BENEFITS:**

- Luminaires adaptable to your specific needs

**FEATURES:**

- **IP 67 rated**
- Premium electronic ballast standard
- Exterior fiberglass housing for corrosion protection
- Every luminaire tested with lamps to assure customer satisfaction
- 5 year limited warranty
- Proudly made in **USA**

## SPECIFICATIONS:

**HOUSING:**

Exterior housing is one piece fiberglass construction with plugs on the ends to access the wireway.

**Marine:** Threaded hubs on the ends to access the wireway.

**REFLECTOR:**

Fabricated of zinc coated steel, painted with a minimum reflectance of 88%.

**GASKETING:**

Thermoset polyurethane, foam in place.

**LENS:**

Linear ribbed clear polycarbonate  
Injection molded polycarbonate

**LATCHING:**

Made of replaceable polycarbonate.

**ELECTRICAL:**

All ballasts and lampholders are UL Listed.

**Marine:** Utilizes a three gang terminal block for electrical connections.

**MOUNTING:**

Surface, for covered ceiling installations.

**LINEAR  
RIBBED CLEAR  
POLYCARBONATE**

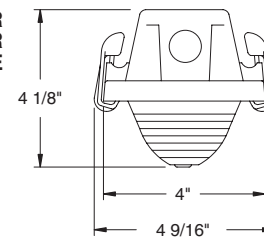

**INJECTION  
MOLDED CLEAR  
POLYCARBONATE**

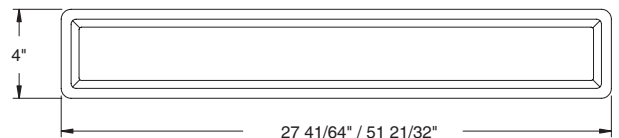
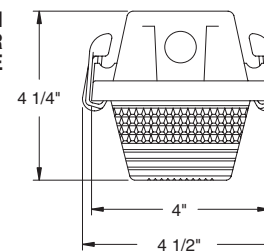

**TAMPER-PROOF LATCH  
ASSEMBLY**

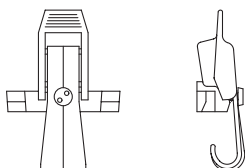

**STAINLESS STEEL HANGER  
(2 PROVIDED PER LUMINAIRE)**

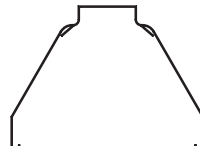



# L1A Series



**PHOTOMETRICS:** For additional photometry, go to [paramountlighting.com](http://paramountlighting.com)

Model L1A1329, 4FT, White Reflector and Clear Polycarbonate Lens, 1 32W T8 Fluorescent Lamp, Lamp Lumen Rating = 2950

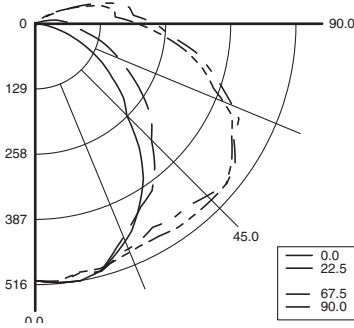

### Coefficients of Utilization, Zonal Cavity Method

Floor Cavity Reflectance: 20%		PCC																							
		.8				.7				.5				.3				.1				0			
PW>		.7	.5	.3	.1	.7	.5	.3	.1	.5	.3	.1	.5	.3	.1	.5	.3	.1	.5	.3	.1	.5	.3	.1	0
R	0	93	93	93	93	90	90	90	90	84	84	84	78	78	78	73	73	73	71	71	71	71	71	71	0
C	1	82	77	73	69	79	74	70	67	69	66	63	64	62	59	60	58	56	53	53	53	53	53	53	0
R	2	73	65	59	53	70	63	57	52	59	54	49	54	50	47	51	47	44	42	42	42	42	42	42	0
	3	66	57	49	43	63	54	48	42	51	45	40	47	42	38	44	40	36	34	34	34	34	34	34	0
	4	60	49	42	36	57	48	40	35	44	38	33	41	36	32	38	34	30	28	28	28	28	28	28	0
	5	55	44	36	30	53	42	35	29	39	33	28	37	31	27	34	30	26	24	24	24	24	24	24	0
	6	51	39	31	26	48	38	31	25	35	29	24	33	28	23	31	26	22	20	20	20	20	20	20	0
	7	47	35	28	22	45	34	27	22	32	26	21	30	25	20	28	23	20	18	18	18	18	18	18	0
	8	43	32	25	20	42	31	24	19	29	23	19	27	22	18	26	21	17	16	16	16	16	16	16	0
	9	40	29	22	18	39	28	22	17	27	21	17	25	20	16	24	19	16	14	14	14	14	14	14	0
	10	38	27	20	16	36	26	20	16	25	19	15	23	18	15	22	17	14	13	13	13	13	13	13	0

### Zonal Lumen Summary

Zone	Lumens	% Lamp	% Luminaire
0-30	405	14	17
0-40	675	23	29
0-60	1314	45	56
0-90	2078	70	88
90-120	270	9	11
90-150	287	10	12
90-180	287	10	12
0-180	2365	80	100

Total Luminaire Optical Efficiency = 80.0%  
Spacing Criterion: 0° = 1.20, 90° = 1.48

## TUFF LITE ORDERING INFORMATION:

SERIES	LAMP QTY	LAMP TYPE	LENS	OPT MATERIAL	OPTIONS	VOLTAGE
L1A Wet Location RL1A Marine Inside ML1A Inside Drip-proof	1 T2 Tandem		8 Linear Ribbed Clear Polycarbonate 9 Injection Molded Clear Polycarbonate		<b>BALLASTS (SPECIFY VOLTAGE)</b> <b>D1</b> Lutron Dimming Eco-10 (T5 Only) <b>D2</b> Electronic Dimming <b>D4</b> < 10% THD (Consult Factory) <b>E9</b> Rapid Start Electronic Ballast <b>FUSING</b> <b>F1</b> GLR/HLR Fusing (Fast) <b>F2</b> GMF/HLR Fusing (Slow) <b>LENSING</b> <b>J0</b> Lamp Sleeves (Specify Color) <b>MOUNTING</b> <b>M11</b> Special Marine Mounting <b>MISC</b> <b>T1</b> Stainless Steel Latches <b>T3</b> Tamper Resistant Latches (Please Specify)	120V-277V/60Hz STD 347V/60Hz 50Hz & Other Voltages Available
<b>14T5</b> F14T5 (2FT) 0° <b>17</b> F17T8 (2FT) 0° <b>28T5</b> F28T5 (4FT) 0° <b>32</b> F32T8 (4FT) 0°						
<b>TANDEM LAMPS</b> Tandem lamps are tandem wired						
<b>14T5</b> F14T5 (4FT) 0° <b>17</b> F17T8 (4FT) 0°						

\*S4 Stainless Steel Interior Metal

\* Note:  
If Stainless Steel is ordered,  
304 SS Standard  
316 SS and other materials  
available, consult agent.

Add hyphens between options

**INDIVIDUAL UNITS STANDARD.**

**Other Wattages Available, Consult Factory.**

**Project Information:**

Information subject to change without notice. Lamps supplied by others.

© 2010 Paramount Industries, Inc. P.O. Box 259 Crosswell, MI 48422