



TECHNISEAL® APPLICATIONS:

- UL/CUL Listed Wet Location
- Cleanroom
(Classes 100-100,000; ISO Classes 5-9)
- NSF Certified Food Processing
(Splash Zone, Food Zone)
- Industrial & Commercial
- UL Listed Marine
(Inside, Inside Drip-Proof)
- Transit

BENEFITS:

- Luminaires adaptable to your specific needs
- Unique 2 inch low profile design

FEATURES:

- Premium electronic ballast standard
- Available in stainless steel construction
- Every luminaire tested with lamps to assure customer satisfaction
- 5 year limited warranty
- Proudly made in **USA**

SPECIFICATIONS:

HOUSING:

Constructed of nominal 20GA (.036) zinc coated steel for unmatched corrosion protection. Knockouts on the back of the luminaire provide wireway access. All seams are sealed with a long life acrylic sealant.

Splash and Food Zone, Marine: Welded, tapered, threaded flanges on the back provide a sealed wireway.

Food Zone: All external metal components of stainless steel (S3 option std).

LENS FRAME:

Exclusively designed, heavy duty, extruded, anodized aluminum with stainless steel captive screws used to hold the lens frame tight to the housing. The frame is supported by two cables while servicing.

Food Zone: All external metal components of stainless steel (S3 option std).

GASKETING:

An extruded, ribbed vinyl gasket seals the lens into the frame, with our exclusive mechanically held, extruded, silicone gasket used to seal the frame to the housing.

Food Zone: Silicone sealant is used to seal the lens into the frame, with EPDM sealing the frame to the housing.

FINISH:

Painted surfaces are two mil white polyester enamel with a minimum reflectance of 88%, special colors available.

LENS:

.140 extruded prismatic acrylic with 50% DR content for durability, smooth side out.

Food Zone: .156 extruded prismatic polycarbonate, smooth side out.

ELECTRICAL:

All ballasts and lampholders are UL Listed.

Marine: Utilizes a three gang terminal block for electrical connections.

MOUNTING:

Surface or custom detail available for covered ceiling installations.

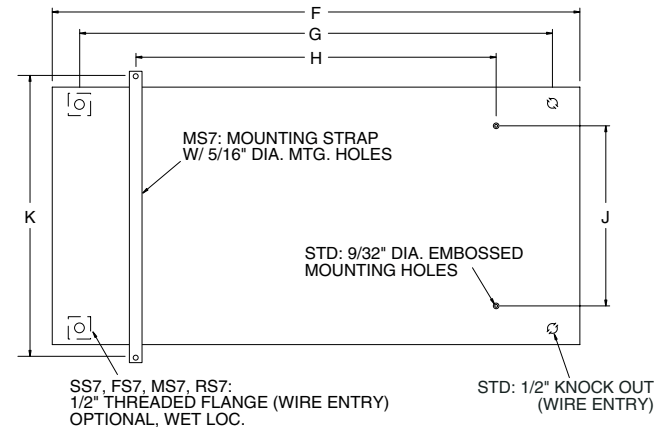
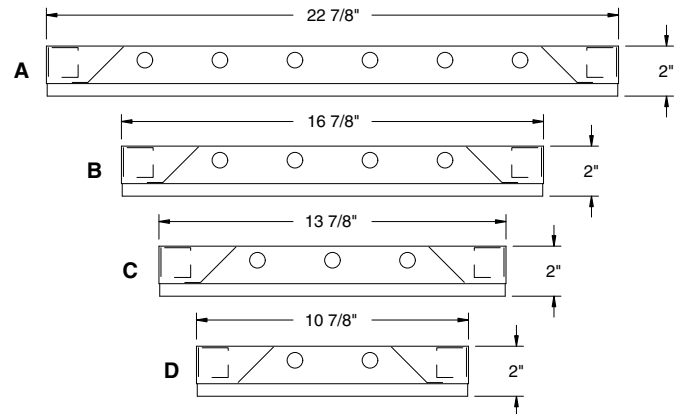

CROSS-SECTION (WIDTH)	DIMENSIONS IN INCHES				
	F	G	H	J	K
A 22 7/8"	22 7/8	20	16	16	24 1/8
	34 7/8	30	16	16	24 1/8
	46 7/8	42	32	16	24 1/8
B 16 7/8"	22 7/8	20	16	10	18 1/8
	34 7/8	30	16	10	18 1/8
	46 7/8	42	32	10	18 1/8

CROSS-SECTION (WIDTH)	DIMENSIONS IN INCHES				
	F	G	H	J	K
C 13 7/8"	22 7/8	20	16	6	15 1/8
	34 7/8	30	16	6	15 1/8
	46 7/8	42	32	6	15 1/8
D 10 7/8"	22 7/8	20	16	4 1/2	12 1/8
	34 7/8	30	16	4 1/2	12 1/8
	46 7/8	42	32	4 1/2	12 1/8

LENS FRAME DETAILS:

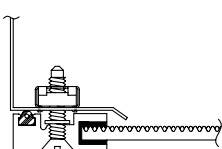

ALUMINUM
LENS FRAME DETAIL

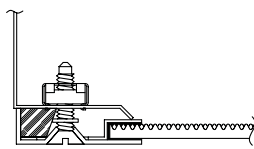

STAINLESS STEEL
LENS FRAME DETAIL

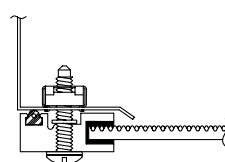

SPLASH ZONE
LENS FRAME DETAIL

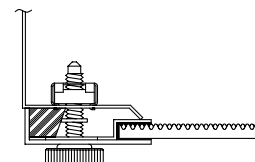

FOOD ZONE
LENS FRAME DETAIL



PHOTOMETRICS:

Model S7A628T54, 4FT, White Painted Interior and Prismatic Acrylic Lens, 6 28W T5 Fluorescent Lamps, Lamp Lumen Rating = 2900

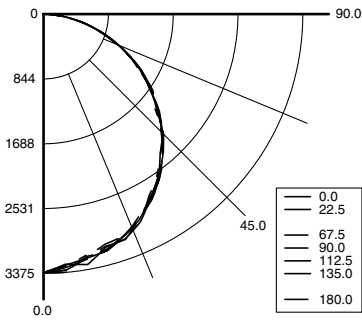

Coefficients of Utilization, Zonal Cavity Method

Floor Cavity Reflectance: 20%

RC	.8				.7				.5				.3				.1				0
RW	.7	.5	.3	.1	.7	.5	.3	.1	.5	.3	.1	.5	.3	.1	.5	.3	.1	.5	.3	.1	0
R 0	65	65	65	65	63	63	63	63	61	61	61	58	58	58	56	56	56	55	55	55	55
C 1	59	57	54	52	58	55	53	51	53	51	50	51	49	48	49	48	47	45	45	45	45
R 2	54	49	45	42	52	48	45	42	46	43	41	44	42	40	43	41	39	38	38	38	38
3	49	43	39	35	48	42	38	35	41	37	34	39	36	34	38	35	33	32	32	32	32
4	45	38	33	30	44	37	33	29	36	32	29	35	31	29	34	31	28	27	27	27	27
5	41	34	29	26	40	33	29	25	32	28	25	31	28	25	30	27	25	23	23	23	23
6	38	31	26	22	37	30	26	22	29	25	22	28	25	22	27	24	22	20	20	20	20
7	35	28	23	20	34	27	23	20	27	22	19	26	22	19	25	22	19	18	18	18	18
8	33	25	21	18	32	25	21	17	24	20	17	24	20	17	23	20	17	16	16	16	16
9	31	23	19	16	30	23	19	16	22	18	16	22	18	16	21	18	15	14	14	14	14
10	29	21	17	14	28	21	17	14	21	17	14	20	17	14	20	16	14	13	13	13	13

Zonal Lumen Summary

Zone	Lumens	% Lamp	% Luminaire
0-30	2573	15	27
0-40	4199	24	44
0-60	7390	42	78
0-90	9462	54	100
90-120	6	0	0
90-150	6	0	0
90-180	6	0	0
0-180	9468	54	100

Total Luminaire Optical Efficiency = 54%
Spacing Criterion: 0° = 1.23, 90° = 1.24

TECHNISEAL® LOW PROFILE SURFACE TROFFER ORDERING INFORMATION:

SERIES	WIDTH	LAMP QTY	LAMP TYPE	LENS	OPT MAT	OPTIONS	VOLTAGE
S7 Wet Location Cleanroom		D 10 7/8" C 13 7/8"		2 .125 Clear Acrylic (No Pattern) 3 .125 White Acrylic		B0 Emergency Bodine LP500 (4FT Only) I9 IOTA ISL-54 Dry (4FT Only)	120V/60Hz Standard 277V/60Hz 347V/60Hz
SS7 Splash Zone		B 16 7/8"		4 .140 Prismatic Acrylic (P12) (base) 6 .125 Clear Polycarbonate (No Pattern)		F1 Fusing GLR/HLR Fusing (Fast) F2 GLM/HLR Fusing (Slow)	50Hz & Other Voltages Available
FS7 Food Zone		A 22 7/8"		7 .125 White Polycarbonate 8 .156 Prismatic Polycarbonate (P12) 9 .187 Tempered Glass (P62)		LENSING H2 .150 Extra Heavy Clear Acrylic H3 .150 Extra Heavy White Acrylic H5 .156 C73 Tempered Glass H6 .187 Clear Tempered Glass J2 .060 Clear Acrylic Overlay J6 .080 Clear Polycarbonate Overlay J9 RFI Lens (Specify Pattern) K1 .156 Prismatic Acrylic (P19) K3 .187 KSH-12 Acri-Tuf Acrylic K6 External Prisms (N/A Splash/Food Zones)	
RS7 Marine Inside				LENSES AVAILABLE FOR FOOD ZONE 6 .125 Clear Polycarbonate (No Pattern) 7 .125 White Polycarbonate 8 .156 Prismatic Polycarbonate (P12) (base) 9 .187 Tempered Glass (P62)		MOUNTING M2 Mounting Bracket Kit (Surface / Chain)	
MS7 Inside Drip-proof				52 Stainless Steel Housing 53 Stainless Steel Exterior 55 Stainless Steel Lens Frame Only		MISC P9 Special Paint Color (Provide Paint Code & Chip) S1 Special Material (Consult Agent) T3 Tamper Resistant (Spanner STD, Others Avail.)	
	14T5 F14T5 (2FT)	0°	2 D, C width 3 C, B width 4 B, A width 6 A width	304 SS Standard, 316 SS and other materials available, consult agent			
	21T5 F21T5 (3FT)	0°					
	28T5 F28T5 (4FT)	0°					

Add hyphens between options

NSF Food Processing Note:

Food Zone (F prefix) luminaires come in DIRECT CONTACT with food.
Splash Zone (S prefix) units may become soiled, but are outside the danger of recontamination.

Project Information:

Information subject to change without notice. Lamps supplied by others.

© 2005 Paramount Industries, Inc. P.O. Box 259 Crosswell, MI 48422