

Z5 Series

FLUORESCENT | SURFACE **S**



SECURITY LITE APPLICATIONS:

- UL/CUL Listed Wet Location
- Industrial & Commercial

BENEFITS:

- Heavy-duty, vandal-resistant
- Luminaires adaptable to your specific needs

FEATURES:

- Premium electronic ballast standard
- Available in stainless steel construction
- Every luminaire tested with lamps to assure customer satisfaction
- 5 year limited warranty
- Proudly made in **USA**

SPECIFICATIONS:

HOUSING:

Constructed of 18GA (.048) zinc coated steel for unmatched corrosion protection. Knockouts are provided on the back of the luminaire for wireway access.

REFLECTOR:

Fabricated of zinc coated steel, painted with a minimum reflectance of 88%.

END CAPS:

Formed of 18GA (.048) stainless steel. Two captive, tamperproof screws secure the end cap to the luminaire housing while positioning the lens.

GASKETING:

EPDM is used in the housing and end caps.

FINISH:

Painted surfaces are two mil of white polyester enamel, special colors available.

LENS:

.125 clear polycarbonate (no pattern).

ELECTRICAL:

All ballasts and lampholders are UL Listed.

MOUNTING:

Surface or custom detail available.

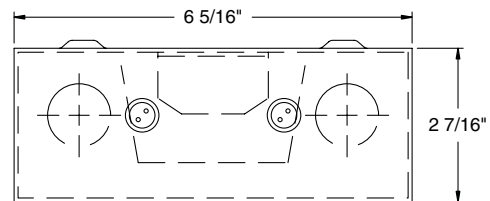

2FT LUMINAIRE

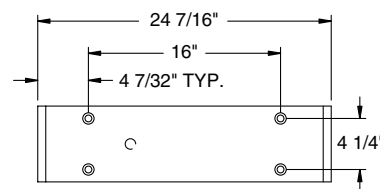

3FT LUMINAIRE

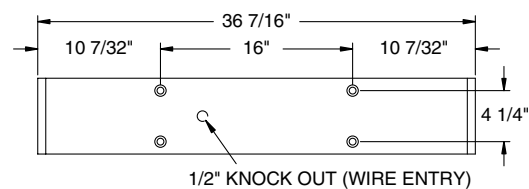

4FT LUMINAIRE

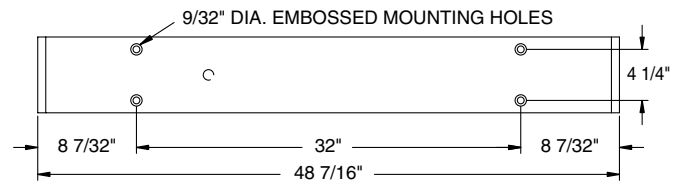



Z5 Series

PHOTOMETRICS:

Model Z52328, 4FT, White Reflector and Prismatic Polycarbonate Lens, 2 32W T8 Fluorescent Lamps, Lamp Lumen Rating = 2950

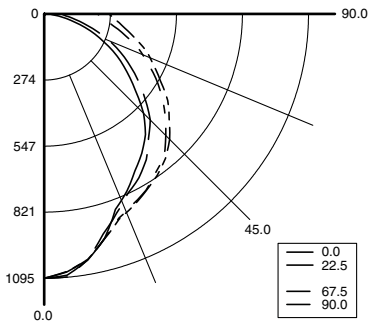

Coefficients of Utilization, Zonal Cavity Method

Floor Cavity Reflectance: 20%

RC	.8				.7				.5				.3				.1				0
RW	.7	.5	.3	.1	.7	.5	.3	.1	.5	.3	.1	.5	.3	.1	.5	.3	.1	.5	.3	.1	0
R 0	63	63	63	63	61	61	61	61	59	59	59	56	56	56	54	54	54	53	53	53	53
C 1	56	53	51	48	55	52	50	47	50	48	46	48	46	44	46	44	43	42	42	42	42
R 2	51	46	42	39	49	45	41	38	43	40	37	41	39	36	40	37	35	34	34	34	34
3	46	40	35	32	45	39	35	31	38	34	31	36	33	30	35	32	30	29	29	29	29
4	42	35	30	27	41	35	30	27	33	29	26	32	29	26	31	28	25	24	24	24	24
5	39	32	27	23	38	31	26	23	30	26	22	29	25	22	28	25	22	21	21	21	21
6	36	28	23	20	35	28	23	20	27	23	20	26	22	19	25	22	19	18	18	18	18
7	33	26	21	18	32	25	21	18	24	20	17	24	20	17	23	20	17	16	16	16	16
8	31	23	19	16	30	23	19	16	22	18	16	22	18	15	21	18	15	14	14	14	14
9	29	22	17	14	28	21	17	14	21	17	14	20	16	14	20	16	14	13	13	13	13
10	27	20	16	13	26	20	16	13	19	15	13	19	15	13	18	15	13	12	12	12	12

Zonal Lumen Summary

Zone	Lumens	% Lamp	% Luminaire
0-30	766	13	25
0-40	1247	21	40
0-60	2233	38	72
0-90	3104	53	100
90-120	0	0	0
90-150	0	0	0
90-180	0	0	0
0-180	3104	53	100

Total Luminaire Optical Efficiency = 53.0%
Spacing Criterion: 0° = 1.03, 90° = 1.15

SECURITY LITE ORDERING INFORMATION:

Z5	2					
SERIES	LAMP QTY	LAMP TYPE	LENS	OPTIONAL MATERIAL	OPTIONS	VOLTAGE
Z5	Wet Location		6 .125 Clear Polycarbonate (No Pattern) (base) 7 .125 White Polycarbonate 8 .156 Prismatic Polycarbonate (P12)	S2 Stainless Steel Outer Channel S3 Stainless Steel Exterior 304 SS Standard, 316 SS and other materials available, consult agent	EMERGENCY B1 Bodine BDL700 (0-50°C) N/A <3FT B2 Bodine BDL500 (0-50°C) N/A <3FT B3 Bodine BDL900 (0-50°C) N/A <3FT BALLASTS D4 < 10% THD (Consult Factory) E9 Rapid Start Electronic Ballast FUSING F1 GLR/HLR Fusing (Fast) F2 GMF/HLR Fusing (Slow) MISC J8 Wire Guard M2 Mounting Bracket Kit (Surface / Chain) P9 Special Paint Color (Provide Paint Code & Chip) S1 Special Material (Specify) Y1 Night Light (Consult Factory)	120V/60Hz Standard 277V/60Hz 347V/60Hz 50Hz & Other Voltages Available
17	F17T8 (2FT)	0°				
25	F25T8 (3FT)	0°				
32	F32T8 (4FT)	0°				

Add hyphens between options

Other Wattages Available, Consult Factory.

Project Information:

Information subject to change without notice. Lamps supplied by others.

© 2005 Paramount Industries, Inc. P.O. Box 259 Crosswell, MI 48422