

PMVRSW7 Stairwell Light - INSTALLATION INSTRUCTIONS

CAUTION: BEFORE CONNECTING THE FIXTURE TO A POWER SUPPLY, MAKE SURE THE POWER IS SWITCHED OFF.



corporate
t 800.521.5405
f 800.852.7154
3625 Swenson Ave.
St. Charles, IL 60174

GENERAL:

1. Before starting the installation, make sure all electricity has been turned off and electrical breaker has been locked out and tagged out.
2. To ensure the success of the installation, be sure to read these instructions and review the diagrams thoroughly before beginning.
3. All electrical connections must be in accordance with local codes, ordinances, or the National Electrical Code.
4. These fixtures are intended to be mounted to a J-Box directly supported by the building structure.
5. All luminaires to be installed by a qualified electrician.

NOTE: The important safeguards and instructions appearing in this manual are not meant to cover all possible conditions and situations that may occur.

INSTALLATION

1. Attach baseplate to J-Box (Checking for level position). Orient "TOP" upwards.
2. Attach wires from power source into fixture.
IMPORTANT: Make sure all connections follow code requirements.
3. Locate the hooks on the bottom of the baseplate. Place them into the slots on the backside of the top cover.
4. Attach the safety carabiner from the top-cover to the baseplate. See Illustration 4 below.
5. Connect wires from power source to top-cover.
6. Gently rotate the top cover into position with the baseplate, so that the two holes at the top align.
7. Fasten the Locking Screw into place

IMPORTANT: All FC/SSL products can be cleaned with non-abrasive and chemical free agents. Use a soft cloth with mild detergent on exterior only.

1 BASE PLATE (INSIDE VIEW)

LENGTH (ft)	WEIGHT (lbs)	DIMENSIONS IN INCHES		
		A	B	C
1	6.1	2.1	8	12
2	8.8	3.9	16	23.75
3	11.7	9.8	16	35.5
4	14.5	7.7	32	47.4

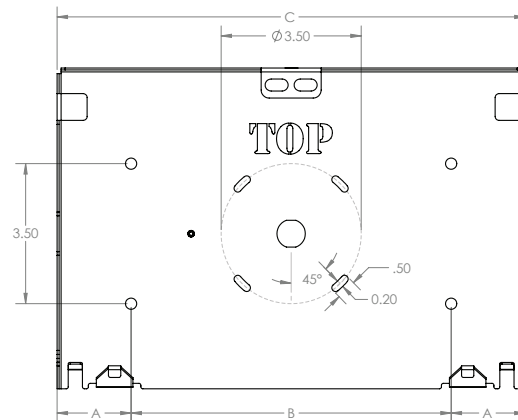

DETAILED ILLUSTRATIONS

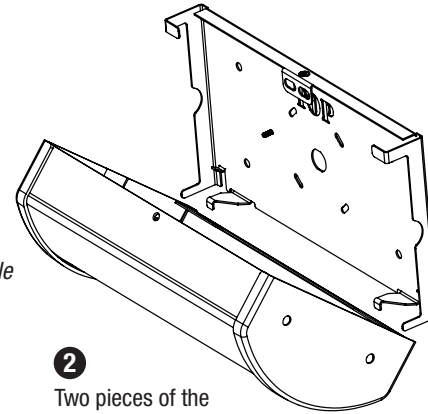

2
Two pieces of the
fixture are prepped
and ready for joining

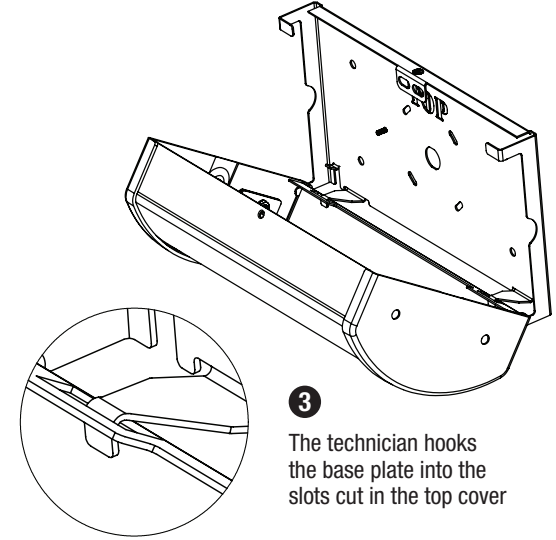

3
The technician hooks
the base plate into the
slots cut in the top cover

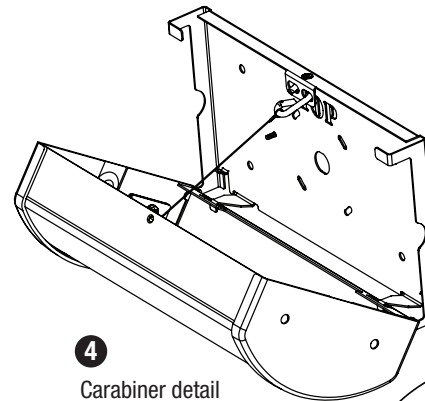

4
Carabiner detail

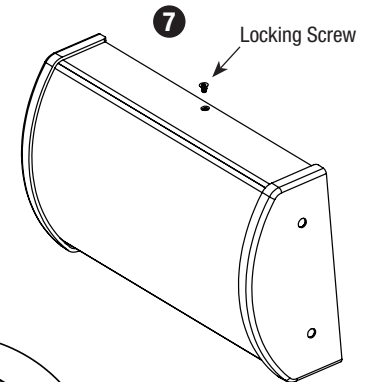

7
Locking Screw

CONFIDENTIAL

THIS DOCUMENT IS THE PROPRIETARY PROPERTY OF PARAMOUNT INDUSTRIES. ANY UNAUTHORIZED TRANSFER, USE OR REPRODUCTION IS STRICTLY PROHIBITED.

iiPMVRSW7
TG-DH-052721

© PARAMOUNT INDUSTRIES